

# PDL S RANGE MAIN SWITCHES



AN INTERNATIONAL  
RANGE OF  
MAIN SWITCHES



PDL ELECTRICAL ACCESSORIES



## “Continuous quality is quality you trust”

Over the last 50 years the PDL Group of Companies has built an enviable international reputation founded on the ethic that “continuous quality is quality you trust”. PDL is globally recognised for manufacturing the very best in electrical accessories, industrial switchgear, AC variable speed drives, custom plastic products and electrical consumer appliances to the highest international standards. Our products are now distributed in more than 40 countries. Continuous investment in research and development has provided our company with some of the most sophisticated worldwide technology and this, together with our innovation and design excellence and independent third party quality assurance schemes have ensured PDL is positioned well in the international market. PDL utilises an independent Telarc accredited electrical laboratory for its product testing and certification to ensure international product acceptance. This combination has underpinned the current success of PDL Holdings’ nine subsidiary companies and their continued further growth. Currently, the Group employs 2000 people over three continents (Australasia, Asia and Europe) and has an annual turnover in excess of £170 million.



PDL Industries Ltd  
Telarc Reg. No 061  
registered to ISO 9002.



**PDL ELECTRICAL  
ACCESSORIES**

Continuous quality is  
quality you trust

## Enclosed Main Switch

PDL's S-Range of enclosed main switches has been developed to produce a fully international, all-purpose isolating switch to meet installation applications for all markets where PDL electrical accessories are distributed. The range has many features and benefits including the facility for padlocking in both the ON and OFF positions. They are made of high impact resistant Polycarbonate and dust and water tested to meet the exacting requirements of International Standard IP66. Components are corrosion resistant through the use of quality brass and stainless steel.

## Versatile Wiring Options

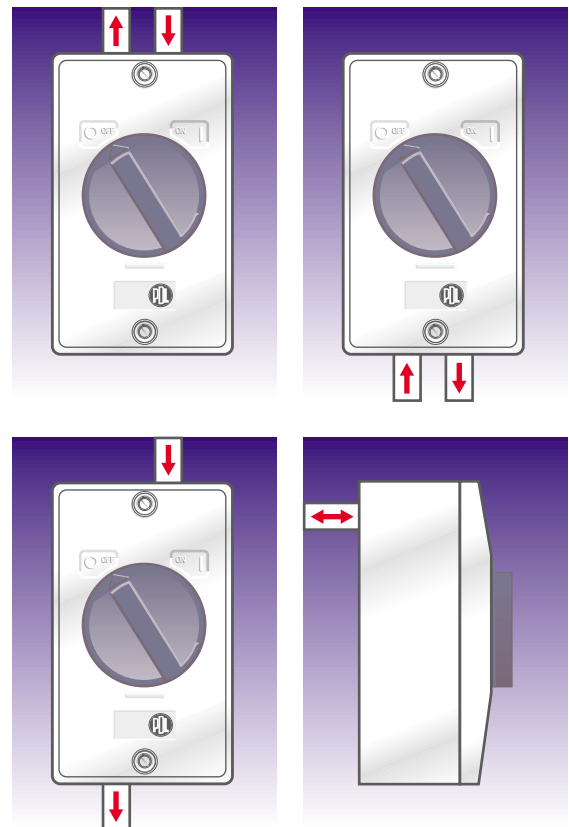

## Enclosed Main Switch (IP66)

- Facility for padlocking in the OFF position provided, padlocking in the ON position possible by field drilling plastic web as instructed.
- Use of high impact resistant materials and synthetic gasket seals ensure environmental resistance to dust and water IP66 rating.
- Ample room for wiring within the enclosure.
- Rotary operation provides ease of use even with gloved hand.
- Choice of enclosure thread configuration - PG conduit entries or metric conduit entries to suit specific markets.
- Supplied with 2 x 25-20mm reducers for optional installation to 20mm conduit (for EM models only).

CATALOGUE NUMBER	S120EM S120PG	S132EM S132PG	S220EM S220PG	S232EM S232PG	S320EM S320PG	S332EM S332PG	S340EM S340PG	S350EM S350PG	S363EM S363PG
Operational Voltage Ue (-50Hz) Volts	250	250	440	440	440	440	440	440	440
Insulation Voltage Ui (-50Hz) Volts	250	250	440	440	440	440	440	440	440
Impulse Withstand Voltage Uimp kV	1.5	1.5	1.5	1.5	1.5	1.5	2.5	2.5	2.5
Rated Thermal Current enclosed Ithe Amps	20	32	20	32	20	32	40	50	63
Rated Duty: uninterrupted	yes	yes	yes	yes	yes	yes	yes	yes	yes
Description	1 pole	1 pole	2 pole	2 pole	3 pole	3 pole	3 pole	3 pole	3 pole
Cable cross-sections solid or stranded	min 2.5 max 16	min 2.5 max 16	min 2.5 max 16	min 2.5 max 16	min 2.5 max 16	min 2.5 max 16	min 2.5 max 25	min 2.5 max 25	min 2.5 max 25
Cable cross-sections flexible	min 2.5 max 10	min 2.5 max 10	min 2.5 max 10	min 2.5 max 10	min 2.5 max 10	min 2.5 max 10	min 2.5 max 16	min 2.5 max 16	min 2.5 max 16
Terminal screw	M5	M5	M5	M5	M5	M5	M6	M6	M6
EN 60947 utilization categories									
AC 21A	250	250	440	440	440	440	440	440	440
Volts									
Amps	20	32	20	32	20	32	40	50	63
Short-time withstand current 1 sec. A	240	384	240	384	240	384	480	600	756
Rated short circuit making capacity kAp	0.5	0.5	0.5	0.5	0.5	0.5	1	1	1
AS 3133 resistive A	20	32	20	32	20	32	40	50	63
inductive AX	20	32	20	32	20	32	40	50	63
M-Rating	M125	M140	M125	M140	M125	M140	M160	M160	M180

EM = M25 metric conduit entries

PG = PG16 conduit entries

## Surface Main Switches

- Facility for padlocking in both the OFF and ON positions provided.
- Facility for sealing wire tie.
- Front or back wiring versions.
- Back wire versions have facility for surface wiring via cut-outs in the switch base.
- Use of high impact resistant materials.
- Ease of mounting with adhesive drilling template.
- Different switching configurations, up for ON or down for ON.



## Surface Main Switches

<b>Rated Current:</b>	20A, 32A, 40A, 50A, 63A & 80A (Single, Double, Triple)
<b>Rated Voltage:</b>	250V a.c. 50Hz (Single) 440V a.c. 50Hz (Double, Triple)
<b>Overall Dimensions:</b>	70.0mm high x 28.4mm wide x 51.0mm deep (Single) 70.0mm high x 52.5mm wide x 51.0mm deep (Double, Triple)
<b>Wiring Options:</b>	Front or back wiring (Single, Double, Triple)
<b>Mounting Centres:</b>	Top right and bottom left corners 60.4mm x 16.0mm (Single, Double, Triple)
<b>Maximum Cable Size:</b>	20A & 32A cable accept 16mm <sup>2</sup> (Single, Double, Triple) 40A, 50A, 63A & 80A cable accept 25mm <sup>2</sup> (Single, Double, Triple)
<b>Type Tested to:</b>	AS3133:1989 (Single, Double, Triple)

SINGLE POLE SWITCH	
Cat No	Description
S120BW	20A Back wire
S132BW	32A Back wire
S140BW	40A Back wire
S150BW	50A Back wire
S163BW	63A Back wire
S180BW	80A Back wire*
S120FW	20A Front wire
S132FW	32A Front wire
S140FW	40A Front wire
S150FW	50A Front wire
S163FW	63A Front wire
S180FW	80A Front wire*
S120BWU	20A Back wire Up for ON
S132BWU	32A Back wire Up for ON
S140BWU	40A Back wire Up for ON
S150BWU	50A Back wire Up for ON
S163BWU	63A Back wire Up for ON
S180BWU	80A Back wire Up for ON*
S120FWU	20A Front wire Up for ON
S132FWU	32A Front wire Up for ON
S140FWU	40A Front wire Up for ON
S150FWU	50A Front wire Up for ON
S163FWU	63A Front wire Up for ON
S180FWU	80A Front wire Up for ON*

DOUBLE POLE SWITCH	
Cat No	Description
S220BW	20A Back wire
S232BW	32A Back wire
S240BW	40A Back wire
S250BW	50A Back wire
S263BW	63A Back wire
S280BW	80A Back wire*
S220FW	20A Front wire
S232FW	32A Front wire
S240FW	40A Front wire
S250FW	50A Front wire
S263FW	63A Front wire
S280FW	80A Front wire*
S220BWU	20A Back wire Up for ON
S232BWU	32A Back wire Up for ON
S240BWU	40A Back wire Up for ON
S250BWU	50A Back wire Up for ON
S263BWU	63A Back wire Up for ON
S280BWU	80A Back wire Up for ON*
S220FWU	20A Front wire Up for ON
S232FWU	32A Front wire Up for ON
S240FWU	40A Front wire Up for ON
S250FWU	50A Front wire Up for ON
S263FWU	63A Front wire Up for ON
S280FWU	80A Front wire Up for ON*

TRIPLE POLE SWITCH	
Cat No	Description
S320BW	20A Back wire
S332BW	32A Back wire
S340BW	40A Back wire
S350BW	50A Back wire
S363BW	63A Back wire
S380BW	80A Back wire*
S320FW	20A Front wire
S332FW	32A Front wire
S340FW	40A Front wire
S350FW	50A Front wire
S363FW	63A Front wire
S380FW	80A Front wire*
S320BWU	20A Back wire Up for ON
S332BWU	32A Back wire Up for ON
S340BWU	40A Back wire Up for ON
S350BWU	50A Back wire Up for ON
S363BWU	63A Back wire Up for ON
S380BWU	80A Back wire Up for ON*
S320FWU	20A Front wire Up for ON
S332FWU	32A Front wire Up for ON
S340FWU	40A Front wire Up for ON
S350FWU	50A Front wire Up for ON
S363FWU	63A Front wire Up for ON
S380FWU	80A Front wire Up for ON*

\* type tested to AS3133:1989 only

PDL Electrical Accessories are designed and engineered to ISO 9001 by PDL Industries, Christchurch, New Zealand, and distributed internationally by:

# PDL ELECTRICAL PRODUCTS



Continuous quality is quality you trust



PDL INTERNATIONAL LTD  
Head Office: 14 Hazeldean Road, Christchurch, New Zealand  
Telephone: +64-3-338 9059, Fax: +64-3-339 1773